

HRC 400 Series Mechanical splices

GEOMETRY

Standard Couplers

HRC 410 (Male)

HRC 420 (Female)

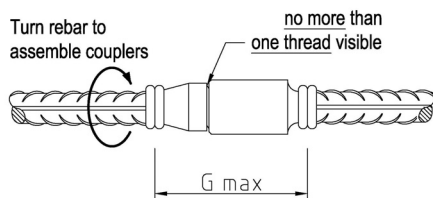
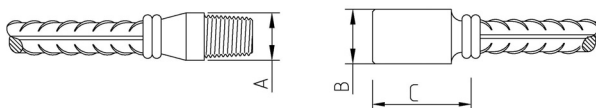

Position Couplers with length adjustment

HRC 410 (Male)

HRC490 (Sleeve)

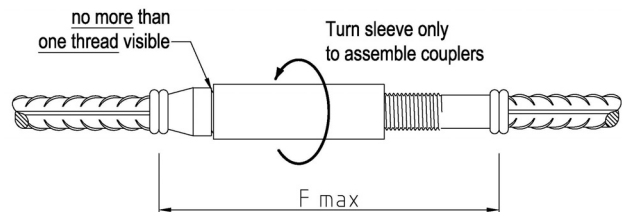
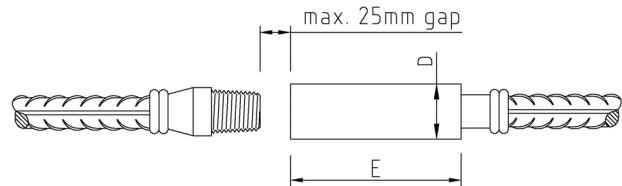

Nominal diameter of reinforcement bar	Sleeve and Thread Dimensions							
Ø	A	B	C	D	E	F max	G max	Torque*
mm	mm	mm	mm	mm	mm	mm	mm	Nm
12	22	22	45	-	-	-	72	160
16	28	28	50	-	-	-	76	200
20	35	35	55	-	-	-	85	200
25	35	42	76	-	-	-	113	270
32	45	55	90	55	157	330	135	270

* recommended torque for fatigue and earthquake loads

INSTALLATION

HRC 410/420

- Remove plastic-plug/cap
- Check for damage / remove dirt etc.
- Screw couplers firmly together by hand
- Visual control: → no full thread visible

HRC 410/490

- Make sure sleeve is positioned as far back onto the straight threaded bolt as possible.
- Remove plastic-plug/cap
- Check for damage / remove dirt etc.
- Both rebar length can be fixed during installation
- Do not exceed maximum gap length between the sleeve and tapered thread end (see sketch above)
- Turn sleeve onto taper threaded end.
- Make sure all threads are engaged on tapered end
- Visual control: → no full thread visible on tapered end